

14

CLINICAL CONNECTIONS & SETTINGS GUIDE

14 controls pronation/supination of Motion Control “6-band” powered wrist and direct pattern recognition command of multifunction grips for past-generation bebionic, TASKA, Aether Zeus Hand, or Psyonic Ability Hand.*

*(*with serial numbers BBHxxxQD, hand will require digital unlock code available upon request from Ottobock)*

PART 1: PHYSICAL CONNECTIONS

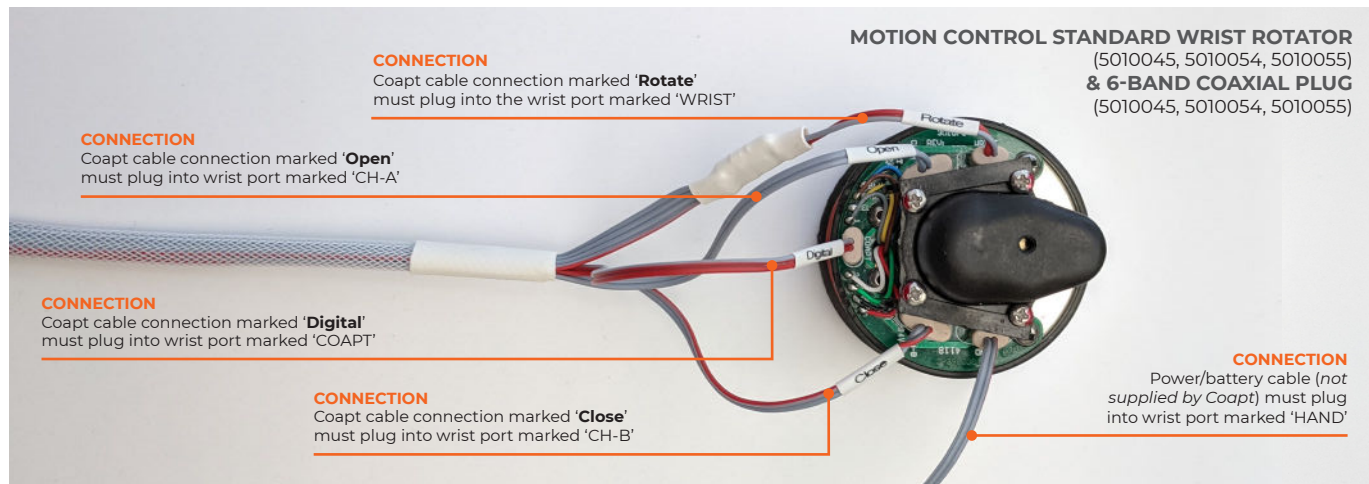

PART 2: SOFTWARE SETTINGS

ELBOW

ESPIRE CLASSIC PLUS

For more information on connecting our Coapt System to this device please reference our Espire Classic Plus + Coapt Compatibilites Guide.



WRISTS

MOTION CONTROL STANDARD WRIST ROTATOR & 6-BAND COAXIAL PLUG

No settings required

HANDS

OTTOBOCK BEBIONIC*

Control Strategy: Dual Site
Open / Close Strategy: Electrodes: A,B
Control Options: Electrodes
Control Response: Proportional

In DEVICE INFORMATION:

- Verify Firmware Rev: v304.032 or greater
- Click License Key
- Note the Serial Number, BT MAC and Contact Ottobock to obtain a License Key
- Click Enable once License Key is entered, then Close
- Press “Send to Hand” to confirm settings changes

In ELECTRODE SCREEN:

- Channel 1 “Blue” threshold: 10%, Channel 1 “Red” threshold: 90%, Channel 2 “Blue” threshold: 10%, Channel 2 “Red” threshold: 90%

Remember to press “Send to Hand” after making any changes

PSYONIC ABILITY HAND

Ensure the “Control System” setting in the PSYONIC ABILITY HAND app is set to “COAPT”

Ensure all other hand settings in the PSYONIC ABILITY HAND app are set to the factory defaults

TASKA

Settings will automatically be set upon each power-on. Use the QR code for more information in the Taska|Coapt Clinician Guide.



AETHER ZEUS HAND

Input Option: EMG, Input Sites: Dual Direct, Speed Control Strategy: Proportional, Grip Switching Mode: Open-Open